

यूनियन बैंक
ऑफ इंडिया
भारत सरकार का उपक्रम



Union Bank
of India
A Government of India Undertaking

UNION BANK OF INDIA

Union Bank of India, Regional Office, First Floor, Begum Bridge Road, Opp Govt. Inter College, Meerut, Uttar Pradesh-250001

(ONLY EMPANELLED CONTRACTORS OF UNION BANK OF INDIA MEERUT REGION ARE ELIGIBLE TO APPLY)

TENDER DOCUMENT FOR FURNISHING WORKS OF ZONAL AUDIT OFFICE / ENQUIRY CELL/ ZONAL VIGILANCE CELL, MEERUT

Consultant: -

**M/s Spirectech Spaces and Architects
(OPC) Private Limited**

Unit No. 241, Shiv Shankar Puri,
Sharda Road, Meerut-250002

Email- ar.himanshujain21@gmail.com

Cont. No.: -9045125056

Annexure-1

FORM OF TENDER

To,

Date _____

The Regional Head,
Union Bank of India, Regional Office,
Begum Bridge Road, Opp Govt. Inter College,
Meerut, Uttar Pradesh-250001

Dear Sir,

Having duly examined the tender documents, including the drawings, specifications, designs, schedule of quantities relating to the works specified in the underwritten memorandum and having visited the site of the said works and having acquired all the requisite information relating thereto as affecting this tender. I/We hereby offer to execute the works specified hereunder within the time specified therein at the rates specified in the Schedule of quantities and in accordance, in all respects, with the specifications, designs, drawings, and instructions in writing referred to in the conditions of tender. The articles of Agreement, special conditions, the schedule of quantities and conditions of contract and with such materials as are specified, by and in all other respects in accordance with such conditions in the schedule of quantities and conditions of contract so far as applicable.

- A) **Name of work** :
- FURNISHING WORKS OF ZONAL AUDIT OFFICE / ENQUIRY CELL/ ZONAL VIGILANCE CELL, MEERUT**
- B) Estimate Cost : **Rs. 22,46,670 + G.S.T.**
- C) Earnest Money : Rs. 45000.00 in form of DD favour of UNION BANK OF INDIA payable at Meerut only. Under MSME category only manufacturers for goods and service providers for services are eligible for exemption for EMD, hence all bidders have to compulsorily Submit EMD.
- D) Percentage If any to be deducted from bills. : **3% (Total of performance security and retention money will be 3 % of the contract value)**
- E) Time Allowed : 45 days from the 7th day from the date of issue of work order
- F) Defect Liability period : Twelve months from the date of virtual completion.
- G) Period of Final Measurement : Within 45 days after the date of virtual completion.
- H) Tender Documents cost : **Rs. 500.00** in form of DD favour of UNION BANK OF INDIA payable at Meerut.

(Signature of the contractor
duly addressed and stamped)

UNION BANK OF INDIA, REGIONAL OFFICE, MEERUT

TENDER NOTICE
(Along with terms & conditions)

FURNISHING WORKS OF OF ZONAL AUDIT OFFICE / ENQUIRY CELL/ ZONAL VIGILANCE CELL, MEERUT

1. Sealed tenders are invited by Union Bank of India, Regional Office, Meerut at First Floor, Begum Bridge Road, Opp Govt. Inter College, Meerut, Uttar Pradesh-250001 for the commissioning & completion of above work. Tenderers are advised to inspect and examine the Site and its surrounding and satisfy themselves before submitting their tenders as also to the nature of the work, the means of access to the Site, etc., and any information they may require. Contractors in general shall themselves obtain all necessary information as to risk and contingencies and other circumstances which may influence or effect their tender. A tenderer shall be deemed to have full knowledge of the site whether he inspects or not and no claims for anything extra consequent upon any misunderstanding or otherwise shall be payable.
2. Submission of a tender by a tenderer implies that he has read this notice and all other contract documents and has made himself aware of the scope and specifications of the work to be done and of conditions and rates at which execution of the work is to be carried out.
3. A tenderer should quote in figures as well as in words the rate(s) tendered. The amount of each item should be worked out and the requisite totals given. Special care shall be taken to write rates in figures as well as in the words and the amounts in figures only in such a way that interpolation is not possible. In case of any discrepancy the rate mentioned in the works shall be taken for evaluation purpose. In case of figures, the words, "Rs" should be written before the figures of rupees and the word "Paisa" after the decimal figure, e.g., Rs.2.16p and in case of word "Rupees" should precede and the "paisa" should be written at the end. Unless the rate is in whole rupees followed by the word "only" it should invariably be up to two places of decimal.
4. All rates should be quoted in the tender form, which shall have to be in sealed cover which shall be super scribe with **"Price Bids for Furnishing Works of Union Bank of India, Zonal Audit Office / Enquiry Cell/ Zonal Vigilance Cell, Meerut"** and name of tenderer firm to be written on sealed cover. **Tenderer shall also enclose their empanelment letter with Union Bank of India RO Meerut.** All pages of the tender documents are to be signed and stamped by tenderer.
5. In case of item rate tenders, only rates quoted shall be recorded. Any tender containing percentage below/above the rates quoted is liable to be rejected. However, where a tenderer voluntarily offers a rebate, this may be considered.
6. The application/Bids form shall also be available at the Bank's website www.unionbankofindia.bank.in. Tenders shall be received by The Chief Manager, Union Bank of India, Regional Office, Meerut, from 22.05.2026 to 29.05.2026 up to 3.00 PM and shall be opened in the office of the Regional Head, Union Bank of India, Meerut First Floor, Begum Bridge Road, Opp Govt. Inter College, Meerut, Uttar Pradesh-250001 on 29.05.2026 at 4:00 P.M. in the presence of tenderers who wish to be present.
7. Contractors to submit all statutory mandatory documents before commencement of project including labor license etc. from competent Authority as Applicable.
8. Retention Money/Earnest Money Deposit refund without any interest after completion of defect liability period (12 Months).
9. Every Tender shall be accompanied by Earnest Money Deposit of Rs. 45000.00 to be submitted in the form of a DD in favor of Union Bank of India, payable at Meerut.

10. If the amount quoted by the L1 bidder is less than 7.5% of the estimated cost, she/he shall submit to Bank an additional performance guarantee of amount equal to the difference in the amount quoted and total estimated cost in the form of DD only.

11. The Earnest Money Deposit/Retention money will be retained in the case of the successful Tenderer as part of the Security Deposit for the due fulfillment of the Contract and will be refunded without any interest after successful completion of deferred liability period of 12 Months after completion of the project by the successful contractor.
12. The EMD of the unsuccessful Tenderer will be returned to them as soon as the Employer takes a decision on the Tender or after the expiry of the validity period of the Tenders whichever is later.
13. A tenderer shall submit the tender who satisfies each and every condition laid down in this notice, failing which, the tender may be rejected.
14. The acceptance of tender will rest with Union Bank of India which does not bind himself to accept the lowest tender and reserve to itself the authority to reject any or all the tenders received without assignment of any reason. All tenders in whom any of the conditions are not fulfilled or are incomplete in any respect are liable to be rejected.
15. Bank further reserves to himself the right of accepting the tender whole or in part and tenderers shall be bound to perform the same at their quoted rates. Also the quantities of items can be increased or decreased as per requirement of the Bank. However, the bank shall entertain no claim on this ground.
16. Since the work to be handed over complete in all respect with 100% workable and functioning condition, so all material shall be F.O.R. site including all taxes like Freights, carriage etc. in respect of this contract shall be payable by the Contractor(s) and the employer will not entertain any claim whatsoever in this respect. Income-tax shall also be deducted as per statutory instructions, from all payments due to the contractor(s).
17. This notice of tender shall form part of the contract documents.
18. The validity for acceptance of the tenders by the employer shall be upto 90 days from the date of opening of tenders.
19. All corrections and over-writings shall have to be initialed by the tenderers. Efforts to be made to avoid overwriting.
20. The bill of quantities attached to the tender documents is only approximate & is likely to be increased or decreased as per site conditions.
21. Incomplete and conditional tenders shall be summarily rejected.
22. Contractor(s) shall be responsible for all defects up to a period of Twelve months from the date of virtual completion of project.
23. Security deposits shall be released after successful completion of defect liability period of twelve months is over from the date of virtual completion of project.
24. Bank shall not arrange/supply of any T & P, labour or material required for the construction and completion of the work.
25. Bank shall not be responsible for any loss or damage to the contractor material, labour or machinery brought by him at site due to any reason or due to any act of God during the course of execution. Contractor shall be liable to make good all the damages, if any till the work is completed and handed over to the Bank Authorities.
26. Work shall have to be completed within 45 days from the 7th day from the date of issue of order. For unnecessary delay on the part of the contractor, they will be liable for penalty @ Rs. 1000/- per day subject to maximum of 5% of awarded sum. Bank may extend the time limit in deserving cases for which request shall have to be made in writing well in time with valid reasons recommended by the Architect.

27. Running payment shall be released after verification of all running bill and final bill by the Architects and final checking of the work done by the Premises department if required. Running payment may be permitted at discretion of the bank. Request for such payment shall not be considered if the value of work done is less than Rs. 7.50 lakh.
28. All frame work drawings for fixing & other working drawing and details shall be supplied by the Contractor & approved by the Architect before starting the job and any clarification can be had from him in his office.
29. The time allowed for the completion of work is 45 days from 7th day after the date of written order to commence the work or after the date on which the site is handed over to the contractor, which so ever is later.
30. Contractor shall make his own arrangement for water supply, electricity and security to his machinery plants & workmen, in case of availability of water and electricity from work, contractor may be allowed to use the same.
31. All rates shall include the complete cleaning of site within the premises and surrounding areas before his submission of final bill and approval from the Architect.
32. If the contractor after receipt of written notice from the Architect requiring compliance within ten days fails to comply with such further drawings/and or architects/ instructions, the employer may employ any other person to execute any such work whatsoever that may be necessary and all cost incurred in connection with this shall be deducted and recoverable from contractors bills by the employer on the certificate from Architect as a debit.
33. Any dispute / disapproval shall be referred to the Competent Authority of the Bank I.e. General Manager (SSD) whose decision shall be final and binding.

Regional Head

SPECIAL CONDITIONS

1. The term Architect mentioned herein shall mean, M/s Spirectech Spaces and Architects (OPC) Private Limited, Unit No. 241, Shiv Shankar Puri, Sharda Road, Meerut-250002 and their associates as nominated by them
2. A schedule of approximate quantities accompanies this tender. It shall be definitely understood that the Architect do not accept any responsibility for the correctness or competence of this schedule in respect of items and quantities and this schedule is liable for alternation by omissions, deductions, or additions at the discretion of the Architect/Employer without in any way affecting the terms of the contract.
3. Contractor's rate must include the cost of transportation of tools and machines to and from the site, all taxes such as sales tax, Excise duty, toll tax and Octroi, Building/construction taxes, Statuary review, if any, etc. and fixing/placing in position in rooms or any designated place for which the item of work is intended to be operated. It must be clearly understood that claim for any extra GST, Octroi, Freight etc. shall not be entertained in any case whatsoever, once the tenders are opened.
4. Since it's a TIME BOUND PROGRAMME the contractor might have to work in odd hours so the contractor's rate shall include the cost of working in multiple shifts around the clock, if necessary, and general lighting and other arrangements required by him for the same under securities arrangement for execution completion of job.
5. The contractor shall not be entitled to any compensation for any loss suffered by him on account of delays in commencing or executing the work, whatsoever the cause for such delays may be, including delays in procuring necessary sanction or approval, etc. except that he shall be granted extension of time as stipulated in the general conditions.
6. The contractor shall co-ordinate with Interior Furnishing and other contractors working on the site and renders all assistance in carrying out the work within the scope of this contract so as to facilitate progress in the Project.
7. All works shall be carried out as per the specifications for the work contained in this document and the details shown on the drawing. Where specifications are not available in this document, the specifications shall be followed as per C.P.W.D. or relevant I.S. codes.
8. Validity: The rates quoted shall remain valid for ninety days for acceptance by the Bank.
9. Mobilization & Secured Advance: No secured advance is payable. Bank shall not sanction any mobilization advance grant to the contractor. Tenders containing any condition for payment of mobilization grant are liable to be rejected.
10. Unless otherwise mentioned all materials shall be I.S.I. marked. In case no particular make is mentioned or the product is not registered with I.S., the contractor shall get the sample(s) approved from the Architect/Employer for those items before using at the work. Failure to do so, work may be rejected and in that case contractor shall have to remove the defective/unapproved material and redo the work for which no claim shall be entertained.
11. Any deviation with respect to time or specifications, Bank without prejudice has the right to:
A) Cancel / Rescind / Revoke the order to the contractor
B) Impose penalty upto 20% of the total value of job to the contractor
12. All tests of materials and work done shall be carried out as per standard mandatory test by the contractor at his own cost from the Govt. Approved lab.
13. Contractor to ensure that work shall be done in such a way that there shall not be any disruption in functioning of branch.
14. Rates submitted by contractor shall include all types of cost including dismantling of Electrical wires and items etc. pertaining to tender available in branch.
15. Bank will open Bids only after obtaining performance report of tenderer from respective FGMO/RO where they are empaneled. In case the report of any tenderer is found unsatisfactory then their bid will be rejected and will not be opened.
16. **If the amount quoted by the L1 bidder is less than 7.5% of the estimated cost, she/he shall submit to Bank a additional performance guarantee of amount equal to the difference in the amount quoted and total estimated cost in the form of DD only.**

PRICE BID

(Furnishing Works of Zonal Audit Office / Enquiry Cell/ Zonal Vigilance Cell, Meerut)

BILL OF QUANTITY FOR FURNISHING WORKS FOR UNION BANK OF INDIA, ZONAL AUDIT OFFICE / ENQUIRY CELL/ ZONAL VIGILANCE CELL, MEERUT, UTTAR PRADESH

A.	FURNISHING WORKS	Qty	Unit	Rate	Amount
S. No.	Description of Work				
1	FALSE CEILING (GYPSUM)				
a.	Providing and fixing GYPSUM BOARD FALSE CEILING in levels as per the detailed drawing - made up of G.I frames as specified by Gypsum India/Saint -Gobain Gyproc and 12mm thick Gypsum board with suitable suspenders fixed to the ceiling. Ceiling section, perimeter channel of size 20X27X30 mm and 0.55 mm thick for light fittings, AC Grills, diffusers, suspenders etc. shall be standard sections supplied by Gypsum India/ Saint Gobain. Spacing of intermediate channels shall be at 1200 mm c/c and ceiling section at 457 mm c/c. The work includes taping and jointing, applying primer, two or more coats of plastic emulsion paint of approved shade ICI/ ASHIAN PAINTS make, making cut-out for light fixtures /fittings, etc. The Final coat shall be done with FOAM ROLLER and no brush marks should be visible. Providing of perimeter channels / beading etc. as per drawing complete in all respects.(All measurement in sqft only and finished surface area shall be	1330	sqft		
b.	FALSE CEILING (GRID- 24"X24")				
	Grid False Ceiling Providing and fixing in the true horizontal level false ceiling system of Armstrong world industries. The suspension system shall be the Armstrong Trulock Silhouette revealed profile grid system with 15mm wide flanges incorporating a 3mm or 6mm central recess color black or white revealed Silhouette main runners and cross tees to have mitered ends with birds mouth notches to provide mitered cruciform junctions. Main runners to be spaced at 12mm c/c fixed by using 2mm pre straightened GI Wire.Main tee, rotary stitched of size 15mm x44mmx3600mm at every 1200mm c/c maximum and 1200mm cross tee of size 15mmx44mm x1200mm at every 600 mm c/c maximum and 600 mm c/c cross tee of size 15 mm x 44 mm x 600 mm at every 1200mm c/c maximum and 19mmx19mmx3000 wall angle. All as per the design and instructions Architects (make, Armstrong & thickness of tile, 16 mm)	970	sqft		
c.	FALSE CEILING (WOODEN BATTENS 3"X4")				
	Providing and fixing wooden battens size of 75mmx100mm of approved shade in approved pattern as directed by the architect. Rates shall be inclusive of all hardware fittings and fixtures as required to fix the same on the ceilings including corner beading and fastners, PU lacquered Polishing & complete in all respects as per detailed drawings to the complete satisfaction of the Architect. Wooden battens- TEAK/ROSEWOOD	211	sqft		
d.	FALSE CEILING (WOODEN BAFFLED)				
	Providing & fixing of wooden Baffle uses a pre-fabricated, veneered member with factory-attached clips for field-attachment of aircraft cable. Baffles are attached via aircraft cable and hex-plug, which is inserted into baffle clips. Aircraft cable is adjustable via a pre-attached cable gripper. Baffles are suspended with a max span of 4' between baffle clips in order to support weight of members. Factory-provided locking biscuit clips snap in place to allow for wood movement across longer span etc. The width of baffle will be 50mm, depth 150mm and placed at 150mm C/C, complete in all respects as per detailed drawings to the complete satisfaction of the Bank/ Architect	150	sqft		
2	PARTITIONS				
a	Low Height Solid Partition Providing & fixing of Low Height Partition (HT. 4'-6") made of 2"x2" aluminium tublar section framework (16 gauge) 2'0" c/c both ways 10 mm MDF BOARD of approved make on both faces finished with 1mm thick laminate of approved shade. Top complete with teak beading, The PU polishing teak sections of approved shade as per drawing and fixing of soft board covering with similar fabric. Complete in all respects to the complete satisfaction of the Architect	210	sqft		
b	Full Height Semi Glazed Partition Providing & fixing of Full Height Semi Glazed Partition (Upto Ceiling Level) partly glazed, made of 2"x2" aluminium tublar section framework (16 gauge) 2'0" c/c both ways 10 mm MDF BOARD of approved make on both faces finished with 1mm thick laminate of approved Make and shade. minimum 12 mm thick toughened glass of approved make with etching/taping as required) on the glazed portion. The work includes PU polishing on woodwork and teak beading etc. Complete in all respects to the complete satisfaction of the Architect. Including doors but excluding cost of door closers mortise locks	550	sqft		
c	Full Height Solid Partition Providing & fixing of Full Height Solid Partition (Upto Ceiling Height), made of 2"x2" aluminium tublar section framework (16 gauge) 2'0" c/c both ways 10 mm MDF BOARD of Approved Make on both faces finished with 1mm thick laminate of approved make & shade The work includes providing PU polishing of shade on woodwork and steam beach beading etc. Including doors but excluding cost of door closers mortise locks. Complete in all respects to the complete satisfaction of the Architect /Engineer	450	sqft		
d	Providing and fixing of following items/ accessories completed in all including				
	(i) Pin Cylinder Motorise lock for doors.(Make Godrej)	6	no.		
	(ii) Hydraulic Door closer.(Make Godrej/ Universal)	6	no.		
	(iii) Door Stopper	6	no.		
3	DOORS				
A	12 MM Thick Toughened Glass Door (Entrance, Branch Head Cabin and Manager Cabin)				
i	Providing and fixing of (3'-0" X 7'-0" and 2'-0" X 7'-0") 12mm toughened glass door with 18" long SS handles, floor spring (Ozone-FS- 9400) etc, locking arrangement of brass make at top of standard make(patch fitting). including fixing of Frosted strip vision film & bank logo as directed by the Bank/ Architects.	152	sqft		
B	BLOCK DOORS Providing and fixing solid core 38 mm solid core flush door finished with lippings in all side with necessary door hinges , cylindrical locks(golden, Godrej) , door clouser, door stoppers, etc with a frame work of T.W./Beech wood size 75mm x 62.5mm with necessary hold fast fixed to the wall/partition. 1 mm laminate to be fixed on both sides duly finished,edges to be finished with wooden lippings.A wooden moulding size 1.5"x2/8" to be provided all along the periferi of the frame work in the both sides . All the wooden area to be duly polished as per specification of the Architect. In case of Partly glazed door 8 mm thk etched toughened glass with granular blasting/sand blasting as per design of the Architect to be fixed with necessary mouldings				
a	Partly Glazed Door with out etching & frosting				
i	(2'-6"/3'-0"x7'-0") for Dining Area, Pantry & UPS Doors	100	sqft		

	b	Blocked Doors for Record Room and Passage				
	i	(2'-6"/3'-0"x7'-0")	50	sqft		
4		COUNTERS AND TABLES				
	a	TABLE For Branch Head Cabin Providing and fixing Branch Head Table with 10mm beveled toughened glass of approved make to be fitted on top obtain the total height of 2'-6" as per detailed drawing, made up of 19mm thick PLYWOOD of approved Make and finished with 1 mm thick laminate of approved make, and shade. Table (with one side drawer unit and another side drawer unit) shall be provided with drawers sliding on telescopic channels and one cabinet with proper locking arrangements and keyboard metal tray. The work includes providing and fixing of foot rests, shelf for CPU, furniture locks, wire managers, spirit polishing of steam beach/ white cedar beading etc. and The inner exposed surfaces to be finished with 0.8mm thick laminate of approved shade, complete in all respects				
	i	Table size: 6'-0" x 3'-0 x 2'-6"	1	no.		
	b	TABLES For Manager Cabin Providing and fixing Manager Table with 10mm beveled toughened glass of approved make to be fitted on top obtain the total height of 2'-6" as per detailed drawing, made up of 19mm thick PLYWOOD of approved Make and finished with 1 mm thick laminate of approved make, and shade. Table (with one side drawer unit and another side drawer unit) shall be provided with drawers sliding on telescopic channels and one cabinet with proper locking arrangements and keyboard metal tray. The work includes providing and fixing of foot rests, shelf for CPU, furniture locks, wire managers, spirit polishing of steam beach/ white cedar beading etc. and The inner exposed surfaces to be finished with 0.8mm thick laminate of approved shade, complete in all respects				
	i	Table size: 6'-0" x 3'-0 x 2'-6"	2	nos		
	c	TABLES For Assistant Manager Providing and fixing Assistant Manager Table made up of 19mm thick PLYWOOD of approved Make and finished with 1 mm thick laminate of approved make, and shade. Table (with one side drawer unit and another side drawer unit) shall be provided with drawers sliding on telescopic channels and one cabinet with proper locking arrangements and keyboard metal tray. The work includes providing and fixing of foot rests, shelf for CPU, furniture locks, wire managers, spirit polishing of steam beach/ white cedar beading etc. and The inner exposed surfaces to be finished with 0.8mm thick laminate of approved shade, complete in all respects to the entire satisfaction of the Architect/Bank				
	i	Table size: 5'-0" x 2'-6 x 2'-6"	4	nos		
	d	TABLES For Working Desk Providing and fixing Working Table made up of 19mm thick PLYWOOD of approved Make and finished with 1 mm thick laminate of approved make, and shade. Table (with one side drawer unit and another side drawer unit) shall be provided with drawers sliding on telescopic channels and one cabinet with proper locking arrangements and keyboard metal tray. The work includes providing and fixing of foot rests, shelf for CPU, furniture locks, wire managers, pin board or soft board, spirit polishing of steam beach/ white cedar beading etc. and The inner exposed surfaces to be finished with 0.8mm thick laminate of approved shade, complete in all respects to the entire satisfaction of the Architect/Bank				
	i	Table size: 4'-0" x 2'-6 x 2'-6"	11	nos		
	e	TABLE For Reception Providing and fixing Working Table made up of 19mm thick PLYWOOD of approved Make and finished with 1 mm thick laminate of approved make, and shade. Table (with one side drawer unit and another side drawer unit) shall be provided with drawers sliding on telescopic channels and one cabinet with proper locking arrangements and keyboard metal tray. The work includes providing and fixing of foot rests, shelf for CPU, furniture locks, wire managers, spirit polishing of steam beach/ white cedar beading etc. and The inner exposed surfaces to be finished with 0.8mm thick laminate of approved shade, complete in all respects to the entire satisfaction of the Architect/Bank				
	i	Table size: 4'-0" x 2'-6 x 2'-6"	1	nos		
5		STORAGE				
	a	Providing & fixing STORAGE CABINETS independent units (movable) 12 feet long (maximum) and 1'-6" deep as per layout plan made up of 19mm board/ply of approved make and finished with 1mm thick laminate of approved make, shade and as per detailed drawing. One shelves made up of 19mm thick board, each drawer(with lock) & cabinet(with lock) 19mm thickness portion every place must be finished with proper liping/ margin teak wood finish. In side and back shall be finished with 0.8mm thick laminate of approved Make and color <i>The work includes supplying fixing of hinges, magnetic catchers, handles</i>				
	i	Side Storage for Branch Head Cabin as per specification as per (a)	10	Sqft		
	ii	Side Storage for Manager Cabin as per specification as per (a)	18	Sqft		
	iii	Side Storage for Assistant Manger Cabin as per specification as per (a)	37	Sqft		
	iv	Low Height Storage (Height-2'-6") for Branch Head Cabin as per specification as per (a)	30	Sqft		
	v	Low Height Storage (Height-2'-6") for Manager Cabin as per specification as per (a)	43	Sqft		
	vi	Low Height Storage (Height-2'-6") for Assistant Manager Cabin as per specification as per (a)	53	Sqft		
	vii	Low Height Storage (Height-4'-0") for Working Hall as per specification as per (a)	93	Sqft		
	viii	Full Height Storage (Height-9'-0") for Record Room as per specification as per (a)	189	Sqft		
	ix	Full Height Storage (Height-9'-0") Beside Branch Head Cabin as per specification as per (a)	111	Sqft		
	x	Full Height Storage (Height-9'-0") Beside Pantry as per specification as per (a)	54	Sqft		
6		COLUMN / WALL PANNELING				
	a	Providing and fixing of wall panelling as per design, consisting of 10 mm thick MDF BOARD of approved Make fixed on wall with made of 2"x2" alluminium tublar section framework (16 gauge) 2'0" c/c both ways. The above shall be laminated with 1mm thick mica of approved Make, The work includes PU polishing of wood beading, complete in all respects as per detailed drawings to the complete satisfaction of the Architect.	1700	sqft		

	b	Providing and fixing of COLUMN PANNELING as per design, with WPC (Wood Polymer Composite) Fluted Panels of size 2950MM (LENGTH)X 195MM (WIDTH) X 27MM(HEIGHT) of LEBEN/ Alutuff / Murrato or other approved make of approved shade in approved pattern as directed by the architect. Rates shall be inclusive of all hardware fittings and fixtures as required to fix the same on the wall and ceilings including corner beading and fastners & complete in all respects as per detailed drawings to the complete satisfaction of the Architect	150	sqft		
	c	Providing & Fixing ACP sheet (4 MM THK) panelling with 2 1/2" x 1 1/2" Aluminium (16 gauge) framework at 2'-0" c/c fixed over the existing wall/ partitions. Approved Make- ALUCOBOND/ ALUDECOR	150	Sft		
	d	Frosted Film -Providing & pasting of frosted film (3M, Garware make) on glass work partition of entrance as required with coloured monograms of the Bank as directed by the consultant/Architect.	200	Sqft		
	e	Supplying , fabricating and installation of "UNION BANK OF INDIA & LOGO" made of coloured acrylic sheet 5-6mm thk in box section, and as per the sizes as mentioned in the detailed drawings . This Coloured Acrylic sheet box logo should be fixed with light from inside so as to have a back lit , as per the direction by the consultant/Architect.	1	no.		
7		Electrical Panel Box: Providing in position full height electric panel box with top, bottom, sides and shutters made out of 19 mm IS 303 MR grade plywood. All internal surface including back/rear side made out of 10 mm thick IS 14276:2016 Bison Board and internal surfaces of electrical panel box to be finished with 3 coats of acrylic paint with smooth finishing. External surface of electrical panel box to be finished in 1.0 mm thick laminate of approved make and shade. Edges of the electrical panel box to be finished with edge banding tape. Electrical Panel Box should be completed with all necessary accessory and hardware including handles, hinges, locks, etc. of approved make complete as per drawing and as directed by Bank or its Architect	63	Sqft		
		TOTAL AMOUNT				
		GST extra as applicable				

RECOMMENDED MAKE TO BE USED

SR.	DESCRIPTION	MAKE / BRANDS
1	MDF. (Medium Density Fibre Board) – CONFIRMING TO IS : 12406 - 2003. (Density: 750 – 850 Kgs/m3) colour code follow as per Bank Norms.	CENTURY/GREENPLY/ DURO/ NATIONAL
2	PLYWOOD – BWP (Boiling Water Resistant, Termite Resistant & Borer Resistant) – CONFIRMING TO IS: 303.	CENTURY/GREENPLY/ DURO/ NATIONAL
3	BLOCK BOARD – CONFIRMING TO IS : 11255 - 2003.	CENTURY/GREENPLY/ DURO/ NATIONAL
4	FLUSH DOOR – CONFIRMING TO IS : 2202 (Part - 1) – 1991.	CENTURY/GREENPLY/ DURO/ NATIONAL
5	LAMINATE – CONFIRMING TO IS : 2046-1995.	CENTURY/GREENLAM/ AICA-SUNMICA
6	Lipping & Moulding	First Class Teak Wood
7	Gypsum ceiling	Gypsum India, Saint - Gobain Gyproc india
8	Grid Ceiling	Armstrong, Dexeun
9	GI Support system for False Ceiling	GYPSTEEL ULTRA
10	Adhesive	Fevicol SH.
11	Locks/Handles & all other hardware	OZONE/Dorma/ Godrej
12	Glass	Modi/Asahi(Tata),Saint Gobain
13	Aluminium	Jindal/ Hindalco/ NALCO
14	Door Closer	OZONE/Dorma/ Godrej
15	FLOOR SPRING	OZONE/Dorma/ Godrej
	Vertical Blinds	Vista
16	Paint	Nerolac / Asian Paints
17	Wood Preservative	Bison by British Paints / Termiseal by ICI
18	Sofa/ Chairs	Godrej/ Durian/Rockworth
19	Presersative	Solignum/Black Japan / Termiseal
20	Sanitary Fittings	Kohler / Hindware
21	CP fittings	Jaguar
22	GI pipe	Jindal/Bhushan
23	Floor & Wall tiles	Nitco/Kajaria
24	Overhead Water tank	Sintex

NOTE:

1- The contractor is strictly advised to use the makes specified/approved by the Bank/Architect, unspecified items will not be paid until they are changed with the specified ones. 2- The Plywood used for the work shall be BWR (Boiling water proof range) confirming to IS 303.

Place:

Date:

Signature of contractor with seal

UNION BANK OF INDIA
(ZONAL OFFICE)

UNION BANK OF INDIA
(ZONAL OFFICE)

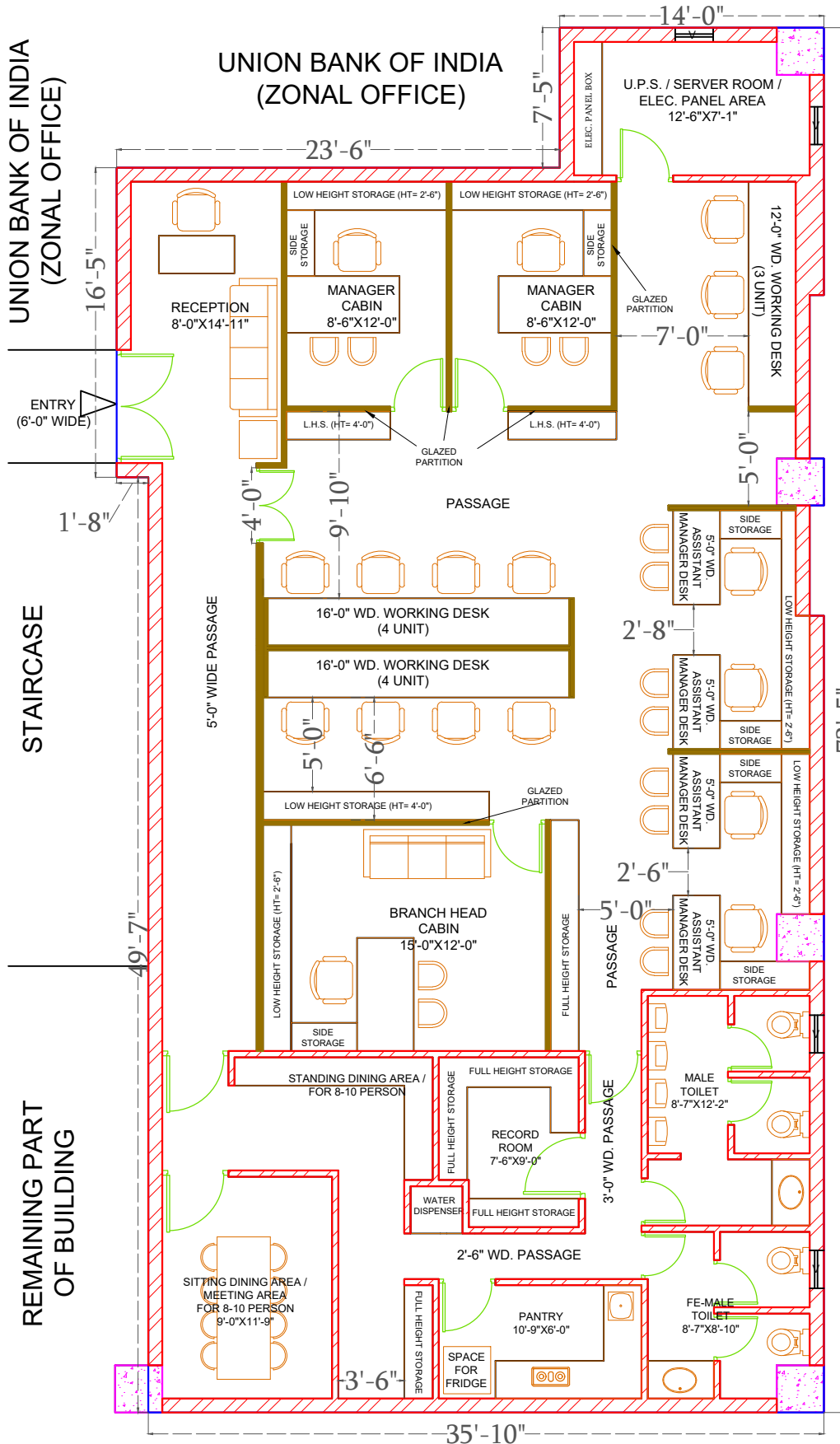

STAIRCASE

REMAINING PART
OF BUILDING

BALCONY / OPEN TO SKY

REMAINING PART OF BUILDING

**SECOND FLOOR PLAN
(PROPOSED)**

PROJECT TITLE:
PROPOSED PLANNING FOR UNION BANK OF INDIA, ZONAL AUDIT OFFICE / ENQUIRY CELL/ ZONAL VIGILANCE CELL, MEERUT, UTTAR PRADESH

LEGEND :

- BRICK WORK
- WOODEN PARTITION
- CONC. WORK
- PREMISES BOUNDARY

NORTH:

OPTION :	E
DATE :	05.05.2026
DRAWING NO. :	01
SHEET NO. :	01
SCALE :	1:100
REVISION :	
REVISION NO :	
REV. DATE :	
DRAFTED BY :	Ar. SHUBHAM PAL
CHECKED BY :	Ar. HIMANSHU JAIN
ARCHITECT SIGN & STAMP :	

COMPANY NAME, ADDRESS & CONTACT NO.
SPIRECTECH SPACES AND ARCHITECTS (OPC) PRIVATE LIMITED
REG OFF. : UNIT NO. 241/1, SHIV SHANKAR PURI, SHARDA ROAD, DISTT. MEERUT (UTTAR PRADESH)-250002
CONTACT NO. : 9045125056
EMAIL ID : AR.HIMANSHUJAIN21@GMAIL.COM