

**यूनियन बैंक**  
ऑफ इंडिया  
भारत सरकार का उपक्रम



**Union Bank**  
of India  
A Government of India Undertaking

**UNION BANK OF INDIA**

Union Bank of India, Regional Office, First Floor, Begum Bridge Road, Opp Govt. Inter College, Meerut, Uttar Pradesh-250001

**(ONLY EMPANELLED CONTRACTORS OF UNION BANK OF INDIA MEERUT REGION ARE ELIGIBLE TO APPLY)**

**TENDER DOCUMENT FOR ELECTRICAL WORKS OF ZONAL AUDIT OFFICE / ENQUIRY CELL/ ZONAL VIGILANCE CELL, MEERUT**

Consultant: -

**M/s Spirectech Spaces and Architects  
(OPC) Private Limited**

Unit No. 241, Shiv Shankar Puri,  
Sharda Road, Meerut-250002

Email- [ar.himanshujain21@gmail.com](mailto:ar.himanshujain21@gmail.com)

Cont. No.: -9045125056

## Annexure-1

### FORM OF TENDER

To,

Date \_\_\_\_\_

**The Regional Head,**  
Union Bank of India, Regional Office,  
Begum Bridge Road, Opp Govt. Inter College,  
Meerut, Uttar Pradesh-250001

Dear Sir,

Having duly examined the tender documents, including the drawings, specifications, designs, schedule of quantities relating to the works specified in the underwritten memorandum and having visited the site of the said works and having acquired all the requisite information relating thereto as affecting this tender. I/We hereby offer to execute the works specified hereunder within the time specified therein at the rates specified in the Schedule of quantities and in accordance, in all respects, with the specifications, designs, drawings, and instructions in writing referred to in the conditions of tender. The articles of Agreement, special conditions, the schedule of quantities and conditions of contract and with such materials as are specified, by and in all other respects in accordance with such conditions in the schedule of quantities and conditions of contract so far as applicable.

- A) **Name of work** :
- ELECTRICAL WORKS OF ZONAL AUDIT OFFICE / ENQUIRY CELL/ ZONAL VIGILANCE CELL, MEERUT**
- B) Estimate Cost : **Rs. 5,95,900 + G.S.T.**
- C) Earnest Money : Rs. 12000.00 in form of DD favour of UNION BANK OF INDIA payable at Meerut only. Under MSME category only manufacturers for goods and service providers for services are eligible for exemption for EMD, hence all bidders have to compulsorily Submit EMD.
- D) Percentage If any to be deducted from bills. : **3% (Total of performance security and retention money will be 3 % of the contract value)**
- E) Time Allowed : 45 days from the 7<sup>th</sup> day from the date of issue of work order
- F) Defect Liability period : Twelve months from the date of virtual completion.
- G) Period of Final Measurement : Within 45 days after the date of virtual completion.
- H) Tender Documents cost : **Rs. 500.00** in form of DD favour of UNION BANK OF INDIA payable at Meerut.

(Signature of the contractor  
duly addressed and stamped)

UNION BANK OF INDIA, REGIONAL OFFICE, MEERUT

TENDER NOTICE  
(Along with terms & conditions)

**ELECTRICAL WORKS OF OF ZONAL AUDIT OFFICE / ENQUIRY CELL/ ZONAL VIGILANCE CELL, MEERUT**

1. Sealed tenders are invited by Union Bank of India, Regional Office, Meerut at First Floor, Begum Bridge Road, Opp Govt. Inter College, Meerut, Uttar Pradesh-250001 for the commissioning & completion of above work. Tenderers are advised to inspect and examine the Site and its surrounding and satisfy themselves before submitting their tenders as also to the nature of the work, the means of access to the Site, etc., and any information they may require. Contractors in general shall themselves obtain all necessary information as to risk and contingencies and other circumstances which may influence or effect their tender. A tenderer shall be deemed to have full knowledge of the site whether he inspects or not and no claims for anything extra consequent upon any misunderstanding or otherwise shall be payable.
2. Submission of a tender by a tenderer implies that he has read this notice and all other contract documents and has made himself aware of the scope and specifications of the work to be done and of conditions and rates at which execution of the work is to be carried out.
3. A tenderer should quote in figures as well as in words the rate(s) tendered. The amount of each item should be worked out and the requisite totals given. Special care shall be taken to write rates in figures as well as in the words and the amounts in figures only in such a way that interpolation is not possible. In case of any discrepancy the rate mentioned in the works shall be taken for evaluation purpose. In case of figures, the words, "Rs" should be written before the figures of rupees and the word "Paisa" after the decimal figure, e.g., Rs.2.16p and in case of word "Rupees" should precede and the "paisa" should be written at the end. Unless the rate is in whole rupees followed by the word "only" it should invariably be up to two places of decimal.
4. All rates should be quoted in the tender form, which shall have to be in sealed cover which shall be super scribe with **"Price Bids for Electrical Works of Union Bank of India, Zonal Audit Office / Enquiry Cell/ Zonal Vigilance Cell, Meerut"** and name of tenderer firm to be written on sealed cover. **Tenderer shall also enclose their empanelment letter with Union Bank of India RO Meerut.** All pages of the tender documents are to be signed and stamped by tenderer.
5. In case of item rate tenders, only rates quoted shall be recorded. Any tender containing percentage below/above the rates quoted is liable to be rejected. However, where a tenderer voluntarily offers a rebate, this may be considered.
6. The application/Bids form shall also be available at the Bank's website [www.unionbankofindia.bank.in](http://www.unionbankofindia.bank.in). Tenders shall be received by The Chief Manager, Union Bank of India, Regional Office, Meerut, from 22.05.2026 to 29.05.2026 up to 3.00 PM and shall be opened in the office of the Regional Head, Union Bank of India, Meerut First Floor, Begum Bridge Road, Opp Govt. Inter College, Meerut, Uttar Pradesh-250001 on 29.05.2026 at 4:00 P.M. in the presence of tenderers who wish to be present.
7. Contractors to submit all statutory mandatory documents before commencement of project including labor license etc. from competent Authority as Applicable.
8. Retention Money/Earnest Money Deposit refund without any interest after completion of defect liability period (12 Months).
9. Every Tender shall be accompanied by Earnest Money Deposit of Rs. 12000.00 to be submitted in the form of a DD in favor of Union Bank of India, payable at Meerut.

**10. If the amount quoted by the L1 bidder is less than 7.5% of the estimated cost, she/he shall submit to Bank an additional performance guarantee of amount equal to the difference in the amount quoted and total estimated cost in the form of DD only.**

11. The Earnest Money Deposit/Retention money will be retained in the case of the successful Tenderer as part of the Security Deposit for the due fulfillment of the Contract and will be refunded without any interest after successful completion of deferred liability period of 12 Months after completion of the project by the successful contractor.
12. The EMD of the unsuccessful Tenderer will be returned to them as soon as the Employer takes a decision on the Tender or after the expiry of the validity period of the Tenders whichever is later.
13. A tenderer shall submit the tender who satisfies each and every condition laid down in this notice, failing which, the tender may be rejected.
14. The acceptance of tender will rest with Union Bank of India which does not bind himself to accept the lowest tender and reserve to itself the authority to reject any or all the tenders received without assignment of any reason. All tenders in whom any of the conditions are not fulfilled or are incomplete in any respect are liable to be rejected.
15. Bank further reserves to himself the right of accepting the tender whole or in part and tenderers shall be bound to perform the same at their quoted rates. Also the quantities of items can be increased or decreased as per requirement of the Bank. However, the bank shall entertain no claim on this ground.
16. Since the work to be handed over complete in all respect with 100% workable and functioning condition, so all material shall be F.O.R. site including all taxes like Freights, carriage etc. in respect of this contract shall be payable by the Contractor(s) and the employer will not entertain any claim whatsoever in this respect. Income-tax shall also be deducted as per statutory instructions, from all payments due to the contractor(s).
17. This notice of tender shall form part of the contract documents.
18. The validity for acceptance of the tenders by the employer shall be upto 90 days from the date of opening of tenders.
19. All corrections and over-writings shall have to be initialed by the tenderers. Efforts to be made to avoid overwriting.
20. The bill of quantities attached to the tender documents is only approximate & is likely to be increased or decreased as per site conditions.
21. Incomplete and conditional tenders shall be summarily rejected.
22. Contractor(s) shall be responsible for all defects up to a period of Twelve months from the date of virtual completion of project.
23. Security deposits shall be released after successful completion of defect liability period of twelve months is over from the date of virtual completion of project.
24. Bank shall not arrange/supply of any T & P, labour or material required for the construction and completion of the work.
25. Bank shall not be responsible for any loss or damage to the contractor material, labour or machinery brought by him at site due to any reason or due to any act of God during the course of execution. Contractor shall be liable to make good all the damages, if any till the work is completed and handed over to the Bank Authorities.
26. Work shall have to be completed within 45 days from the 7<sup>th</sup> day from the date of issue of order. For unnecessary delay on the part of the contractor, they will be liable for penalty @ Rs. 1000/- per day subject to maximum of 5% of awarded sum. Bank may extend the time limit in deserving cases for which request shall have to be made in writing well in time with valid reasons recommended by the Architect.

27. Running payment shall be released after verification of all running bill and final bill by the Architects and final checking of the work done by the Premises department if required. Running payment may be permitted at discretion of the bank. Request for such payment shall not be considered if the value of work done is less than Rs. 2.00 lakh.
28. All frame work drawings for fixing & other working drawing and details shall be supplied by the Contractor & approved by the Architect before starting the job and any clarification can be had from him in his office.
29. The time allowed for the completion of work is 45 days from 7<sup>th</sup> day after the date of written order to commence the work or after the date on which the site is handed over to the contractor, which so ever is later.
30. Contractor shall make his own arrangement for water supply, electricity and security to his machinery plants & workmen, in case of availability of water and electricity from work, contractor may be allowed to use the same.
31. All rates shall include the complete cleaning of site within the premises and surrounding areas before his submission of final bill and approval from the Architect.
32. If the contractor after receipt of written notice from the Architect requiring compliance within ten days fails to comply with such further drawings/and or architects/ instructions, the employer may employ any other person to execute any such work whatsoever that may be necessary and all cost incurred in connection with this shall be deducted and recoverable from contractors bills by the employer on the certificate from Architect as a debit.
33. Any dispute / disapproval shall be referred to the Competent Authority of the Bank I.e. General Manager (SSD) whose decision shall be final and binding.

**Regional Head**

## SPECIAL CONDITIONS

1. The term Architect mentioned herein shall mean, M/s Spirectech Spaces and Architects (OPC) Private Limited, Unit No. 241, Shiv Shankar Puri, Sharda Road, Meerut-250002 and their associates as nominated by them
2. A schedule of approximate quantities accompanies this tender. It shall be definitely understood that the Architect do not accept any responsibility for the correctness or competence of this schedule in respect of items and quantities and this schedule is liable for alternation by omissions, deductions, or additions at the discretion of the Architect/Employer without in any way affecting the terms of the contract.
3. Contractor's rate must include the cost of transportation of tools and machines to and from the site, all taxes such as sales tax, Excise duty, toll tax and Octroi, Building/construction taxes, Statuary review, if any, etc. and fixing/placing in position in rooms or any designated place for which the item of work is intended to be operated. It must be clearly understood that claim for any extra GST, Octroi, Freight etc. shall not be entertained in any case whatsoever, once the tenders are opened.
4. Since it's a TIME BOUND PROGRAMME the contractor might have to work in odd hours so the contractor's rate shall include the cost of working in multiple shifts around the clock, if necessary, and general lighting and other arrangements required by him for the same under securities arrangement for execution completion of job.
5. The contractor shall not be entitled to any compensation for any loss suffered by him on account of delays in commencing or executing the work, whatsoever the cause for such delays may be, including delays in procuring necessary sanction or approval, etc. except that he shall be granted extension of time as stipulated in the general conditions.
6. The contractor shall co-ordinate with Interior Furnishing and other contractors working on the site and renders all assistance in carrying out the work within the scope of this contract so as to facilitate progress in the Project.
7. All works shall be carried out as per the specifications for the work contained in this document and the details shown on the drawing. Where specifications are not available in this document, the specifications shall be followed as per C.P.W.D. or relevant I.S. codes.
8. Validity: The rates quoted shall remain valid for ninety days for acceptance by the Bank.
9. Mobilization & Secured Advance: No secured advance is payable. Bank shall not sanction any mobilization advance grant to the contractor. Tenders containing any condition for payment of mobilization grant are liable to be rejected.
10. Unless otherwise mentioned all materials shall be I.S.I. marked. In case no particular make is mentioned or the product is not registered with I.S., the contractor shall get the sample(s) approved from the Architect/Employer for those items before using at the work. Failure to do so, work may be rejected and in that case contractor shall have to remove the defective/unapproved material and redo the work for which no claim shall be entertained.
11. Any deviation with respect to time or specifications, Bank without prejudice has the right to:  
A) Cancel / Rescind / Revoke the order to the contractor  
B) Impose penalty upto 20% of the total value of job to the contractor
12. All tests of materials and work done shall be carried out as per standard mandatory test by the contractor at his own cost from the Govt. Approved lab.
13. Contractor to ensure that work shall be done in such a way that there shall not be any disruption in functioning of branch.
14. Rates submitted by contractor shall include all types of cost including dismantling of Electrical wires and items etc. pertaining to tender available in branch.
15. Bank will open Bids only after obtaining performance report of tenderer from respective FGMO/RO where they are empaneled. In case the report of any tenderer is found unsatisfactory then their bid will be rejected and will not be opened.
16. **If the amount quoted by the L1 bidder is less than 7.5% of the estimated cost, she/he shall submit to Bank a additional performance guarantee of amount equal to the difference in the amount quoted and total estimated cost in the form of DD only.**

## **PRICE BID**

(Electrical Works of Zonal Audit Office / Enquiry Cell/ Zonal Vigilance Cell,  
Meerut)

**BILL OF QUANTITY FOR ELECTRICAL WORK FOR UNION BANK OF INDIA, ZONAL AUDIT OFFICE / ENQUIRY CELL/ ZONAL VIGILANCE CELL, MEERUT, UTTAR PRADESH**

B. ELECTRICAL WORKS					
S. No.	Description of Work	UNIT	QTY	RATE	AMOUNT
1	<b>Light Primary Points in PVC Conduit -</b> Point Wiring for light points, controlled through modular switches complete with PVC boxes & cover plate - The point wiring shall be done with 3x 1.5 sq.mm Fire Resistant Low smoke Low Halogen stranded Cu. Wire in PVC conduit pipe (HMS Grade) concealed in wall/ floor/ panelling/ partitions or above false ceiling as per requirement. The work shall also include for cutting chase for conduits and moulded boxes, if required, in the wall/ floor (Without damaging the building/wall) along with clamping the conduit at every 600 mm interval & finally finishing the surface & matching the same with the existing surface. The rate should include the cost of all materials, modular switch complete with PVC box & cover plate, labour, T&P, scaffolding, shifting of furniture, carting away the debris and cleaning the floor etc. The job shall be complete & to the entire satisfaction of the Bank. Circuit wiring to be included in the point wiring rates. The circuit wiring starts from DB to point control box/ switch box using Fire Resistant Low smoke Low Halogen stranded Cu. Wire 2x2.5 sqmm & 1x2.5 sqmm earthing (min size) in 20/25/32 mm PVC conduit. All the wiring shall be carried out in recessed conduits unless instructed by Architect / Engineer in charge	Each	110		
2	<b>Light Secondary Points in PVC Conduit -</b> Point Wiring for light points, controlled through modular switches complete with PVC boxes & cover plate - The point wiring shall be done with 3x 1.5 sq.mm Fire Resistant Low smoke Low Halogen stranded Cu. Wire in PVC conduit pipe (HMS Grade) concealed in wall/ floor/ panelling/ partitions or above false ceiling as per requirement. The work shall also include for cutting chase for conduits and moulded boxes, if required, in the wall/ floor (Without damaging the building/wall) along with clamping the conduit at every 600 mm interval & finally finishing the surface & matching the same with the existing surface. The rate should include the cost of all materials, modular switch complete with PVC box & cover plate, labour, T&P, scaffolding, shifting of furniture, carting away the debris and cleaning the floor etc. The job shall be complete & to the entire satisfaction of the Bank. Circuit wiring to be included in the point wiring rates. The circuit wiring starts from DB to point control box/ switch box using Fire Resistant Low smoke Low Halogen stranded Cu. Wire 2x2.5 sqmm & 1x2.5 sqmm earthing (min size) in 20/25/32 mm PVC conduit. All the wiring shall be carried out in recessed conduits unless instructed by Architect / Engineer in charge	Each	35		
3	<b>5/6A Primary point in PVC Conduit:-</b> Supply & Installation of point wiring for Raw power plug points on workstations / table/ wall using 2X2.5 + 1x2.5 Sq.mm FR LSH ( Fire Resistant Low smoke Low Halogen) copper conductor PVC sheathed flexible wire pulled from distribution board through PVC Conduit pipe (HMS Grade) concealed in wall/ floor/ panelling/ partitions or above false ceiling as per requirement. Each point consisting of 1 nos of 6/10A , 3/5 pin sockets & 1 No.,6/10A Switch , wired together forming one point. The earth wire of green color only. The work shall also include for cutting chase for conduits and moulded boxes, if required, in the wall/ floor (Without damaging the building/wall) along with clamping the conduit at every 600mm interval & finally finishing the surface & matching the same with the existing surface. The rate should include the cost of all materials, labour, T&P, scaffolding, shifting of furniture, carting away the debris and cleaning the floor etc. The job shall be complete & to the entire satisfaction of the Bank. The above includes supply & fixing modular cover plates, base plates, PVC box/ Gang box in brick wall by making necessary chase/ recess and making good the same. All switches sockets and accessories must be modular. All new points must be provided in concealed /recessed conduit unless directed by architect / engineer in charge Interconnections to movable furniture, if any, shall be done using flexible PVC Conduit with end couplers.	Each	35		
4	<b>5/6A Secondary point in PVC Conduit:-</b> Supply & Installation of point wiring for Raw power plug points on workstations / table/ wall using 2X2.5 + 1x2.5 Sq.mm FR LSH ( Fire Resistant Low smoke Low Halogen) copper conductor PVC sheathed flexible wire pulled from nearby point through PVC Conduit pipe (HMS) concealed in wall/ floor/ panelling/ partitions or above false ceiling as per requirement. Each point consisting of 1 nos of 6/10A , 3/5 pin sockets & 1 No. 6/10A Switch , wired together forming one point. The earth wire of green color only. The work shall also include for cutting chase for conduits and moulded boxes, if required, in the wall/ floor (Without damaging the building/wall) along with clamping the conduit at every 600mm interval & finally finishing the surface & matching the same with the existing surface. The rate should include the cost of all materials, labour, T&P, scaffolding, shifting of furniture, carting away the debris and cleaning the floor etc. The job shall be complete & to the entire satisfaction of the Bank. The above includes supply & fixing modular cover plates, base plates, PVC box/ Gang box in brick wall by making necessary chase/ recess and making good the same. All switches sockets and accessories must be modular. All new points must be provided in concealed/recessed conduit unless directed by architect / engineer in charge Interconnections to movable furniture, if any, shall be done using flexible PVC Conduit with end couplers.	Each	8		
5	<b>UPS Primary point in PVC Conduit:-</b> Supply & Installation of point wiring for UPS points on workstations / table/ wall using 2X2.5 + 1x2.5 Sq.mm FR LSH ( Fire Resistant Low smoke Low Halogen) copper conductor PVC sheathed flexible wire pulled from distribution board through PVC Conduit pipe (HMS Grade) concealed in wall/ floor/ panelling/ partitions or above false ceiling as per requirement. Each point consisting of 3 nos of 6/10A , 3/5 pin sockets & 1 No.,6/10A Switch , wired together forming one point. The earth wire of green color only. The work shall also include for cutting chase for conduits and moulded boxes, if required, in the wall/ floor (Without damaging the building/wall) along with clamping the conduit at every 600mm interval & finally finishing the surface & matching the same with the existing surface. The rate should include the cost of all materials, labour, T&P, scaffolding, shifting of furniture, carting away the debris and cleaning the floor etc. The job shall be complete & to the entire satisfaction of the Bank. The above includes supply & fixing modular cover plates, base plates, PVC box/ Gang box in brick wall by making necessary chase/ recess and making good the same. All switches sockets and accessories must be modular. All new points must be provided in concealed/recessed conduit unless directed by architect / engineer in charge Interconnections to movable furniture, if any, shall be done using flexible PVC Conduit with end couplers.	Each	25		
6	<b>UPS secondary point in PVC Conduit:-</b> Supply & Installation of point wiring for UPS points on workstations / table/ wall using 2X2.5 + 1x2.5 Sq.mm FR LSH ( Fire Resistant Low smoke Low Halogen) copper conductor PVC sheathed flexible wire looped from nearest UPS point through PVC Conduit pipe (HMS Grade) concealed in wall/ floor/ panelling/ partitions or above false ceiling as per requirement. Each point consisting of 3 nos of 6/10A , 3/5 pin sockets & 1 No., 6/10A Switch , wired together forming one point. The earth wire of green color only. The work shall also include for cutting chase for conduits and moulded boxes, if required, in the wall/ floor (Without damaging the building/wall) along with clamping the conduit at every 600mm interval & finally finishing the surface & matching the same with the existing surface. The rate should include the cost of all materials, labour, T&P, scaffolding, shifting of furniture, carting away the debris and cleaning the floor etc. The job shall be complete & to the entire satisfaction of the Bank. The above includes supply & fixing modular cover plates, base plates, PVC box/ Gang box in brick wall by making necessary chase/ recess and making good the same. All switches sockets and accessories must be modular. All new points must be provided in concealed/recessed conduit unless directed by architect / engineer in charge Interconnections to movable furniture, if any, shall be done using flexible PVC Conduit with end couplers.	Each	6		
7	<b>15/16A Primary point in PVC Conduit:-</b> Supply & Installation of point wiring for Raw power plug points on workstations / table/ wall using 2X4 + 1x4 Sq.mm FR LSH ( Fire Resistant Low smoke Low Halogen) copper conductor PVC sheathed flexible wire pulled from distribution board through PVC Conduit pipe (HMS Grade) concealed in wall/ floor/ panelling/ partitions or above false ceiling as per requirement. Each point consisting of 1 nos of 16/20A , 3/5 pin sockets & 1 No., 16/20A Switch , wired together forming one point. The earth wire of green color only. The work shall also include for cutting chase for conduits and moulded boxes, if required, in the wall/ floor (Without damaging the building/wall) along with clamping the conduit at every 600mm interval & finally finishing the surface & matching the same with the existing surface. The rate should include the cost of all materials, labour, T&P, scaffolding, shifting of furniture, carting away the debris and cleaning the floor etc. The job shall be complete & to the entire satisfaction of the Bank. The above includes supply & fixing modular cover plates, base plates, PVC box/ Gang box in brick wall by making necessary chase/ recess and making good the same. All switches sockets and accessories must be modular. All new points must be provided in concealed /recessed conduit unless directed by architect / engineer in charge Interconnections to movable furniture, if any, shall be done using flexible PVC Conduit with end couplers.	Each	12		

8	<b>15/16A Secondary point in PVC Conduit:-</b> Supply & Installation of point wiring for Raw power plug points on workstations / table/ wall using 2X4 + 1x4 Sq.mm FR LSH ( Fire Resistant Low smoke Low Halogen) copper conductor PVC sheathed flexible wire pulled from nearest power point through PVC Conduit pipe (HMS Grade) concealed in wall/ floor/ panelling/ partitions or above false ceiling as per requirement. Each point consisting of 1 nos of 16/20A , 3/5 pin sockets & 1 No.,16/20A Switch , wired together forming one point. The earth wire of green color only. The work shall also include for cutting chase for conduits and moulded boxes, if required, in the wall/ floor (Without damaging the building/wall) along with clamping the conduit at every 600mm interval & finally finishing the surface & matching the same with the existing surface.The rate should include the cost of all materials, labour, T&P, scaffolding, shifting of furniture, carting away the debris and cleaning the floor etc.The job shall be complete & to the entire satisfaction of the Bank. The above includes supply & fixing modular cover plates, base plates, PVC box/ Gang box in brick wall by making necessary chase/ recess and making good the same. All switches sockets and accessories must be modular. All new points must be provided in concealed/ recessed conduit unless directed by architect / engineer in charge Interconnections to movable furniture, if any, shall be done using flexible PVC Conduit with end couplers.	Each	5		
9	<b>AC point in PVC Conduit:-</b> Supply & Installation of point wiring for Air Conditioner on workstations / table/ wall using 2X4 + 1x4 Sq.mm FR LSH ( Fire Resistant Low smoke Low Halogen) copper conductor PVC sheathed flexible wire pulled from distribution board through PVC Conduit pipe (HMS Grade) concealed in wall/ floor/ panelling/ partitions or above false ceiling as per requirement. Each point consisting of 1 nos of 20/25A , 3/5 pin sockets & 1 No. Single module 20/25A MCB, 1 Nos 25A Motor starter switch wired together forming one point. The earth wire of green color only. The work shall also include for cutting chase for conduits and moulded boxes, if required, in the wall/ floor (Without damaging the building/wall) along with clamping the conduit at every 600mm interval & finally finishing the surface & matching the same with the existing surface.The rate should include the cost of all materials, labour, T&P, scaffolding, shifting of furniture, carting away the debris and cleaning the floor etc.The job shall be complete & to the entire satisfaction of the Bank. The above includes supply & fixing modular cover plates, base plates, PVC box/ Gang box in brick wall by making necessary chase/ recess and making good the same. All switches sockets and accessories must be modular. All new points must be provided in concealed/recessed conduit unless directed by architect / engineer in charge Interconnections to movable furniture, if any, shall be done using flexible PVC Conduit with	Each	10		
10	Supply and laying 20 mm PVC conduit (MHS Grade) through wall / floor / above false ceiling / partition etc. The work shall also include for cutting chase for conduits and moulded boxes, if required, in the wall/ floor (Without damaging the building/wall) along with clamping the conduit at every 600mm interval & finally finishing the surface & matching the same with the existing surface.The rate should include the cost of all materials, labour, T&P, scaffolding, shifting of furniture, carting away the debris and cleaning the floor etc.	RM	45		
11	Supply and laying 25 mm PVC conduit (HMS Grade) through wall / floor / above false ceiling / partition etc. The work shall also include for cutting chase for conduits and moulded boxes, if required, in the wall/ floor (Without damaging the building/wall) along with clamping the conduit at every 600mm interval & finally finishing the surface & matching the same with the existing surface.The rate should include the cost of all materials, labour, T&P, scaffolding, shifting of furniture, carting away the debris and cleaning the floor etc.	RM	35		
12	<b>3x6 sq mm submains wiring in PVC conduit:-</b> Supply and laying of 2x6 sq mm + 1x6 sq mm FR LSH ( Fire Resistant Low smoke Low Halogen) stranded Cu. Wire in PVC Conduit (HMS Grade) through wall / floor / above false ceiling / partition etc. The work shall also include for cutting chase for conduits and moulded boxes, if required, in the wall/ floor (Without damaging the building/wall) along with clamping the conduit at every 600mm interval & finally finishing the surface & matching the same with the existing surface.The rate should include the cost of all materials, labour, T&P, scaffolding, shifting of furniture, carting away the debris and cleaning the floor etc.	RM	50		
13	Supply and laying of 3x10 submains wiring in PVC conduit Supply and laying of 2x10 sq mm + 1x10 sq mm FR ( Fire Resistant) stranded Cu. Wire in PVC Conduit (HMS Grade) through wall / floor / above false ceiling / partition etc. The work shall also include for cutting chase for conduits and moulded boxes, if required, in the wall/ floor (Without damaging the building/wall) along with clamping the conduit at every 600mm interval & finally finishing the surface & matching the same with the existing surface.The rate should include the cost of all materials, labour, T&P, scaffolding, shifting of furniture, carting away the debris and cleaning the floor etc.	RM	40		
14	Supply and laying of 4x10 flexible wire in PVC Conduit Supply and laying of 3x10 sq mm + 1x10 sq mm FR ( Fire Resistant) stranded Cu. Wire in PVC Conduit (HMS Grade) through wall / floor / above false ceiling / partition etc. The work shall also include for cutting chase for conduits and moulded boxes, if required, in the wall/ floor (Without damaging the building/wall) along with clamping the conduit at every 600mm interval & finally finishing the surface & matching the same with the existing surface.The rate should include the cost of all materials, labour, T&P, scaffolding, shifting of furniture, carting away the debris and cleaning the floor etc.	RM	30		
15	Supply installation testing and commissioning of 4 way SPN DB flush mounted on wall, sheet metal fabricated, powder coated, having dust-proof and vermin 'proof, gasketed and hinged door with all internals such as DIN rails, neutral link, interconnected wiring, complete with earthing legs, housing following switch gears(Double door HORIZONTAL DB ) with 2 Nos 63A DP MCB for Single Phase UPS input and output isolation	Set	2		
16	SITC of 12 way SPN DB flush mounted on wall, sheet metal fabricated, powder coated, having dust-proof and vermin 'proof, gasketed and hinged door with all internals such as DIN rails, neutral link, interconnected wiring, complete with earthing legs, housing following switch gears(Double door HORIZONTAL DB ) i/c 1 Nos 63A DP MCB o/g 10 nos SP MCB (6-32A) 10 KA Breaking Capacity	Set	2		
17	SITC of 4 way Horizontal DB flush mounted on wall, sheet metal fabricated, powder coated, having dust- proof and vermin'proof, gasketed and hinged door with all internals such as DIN rails, neutral link, interconnected wiring, complete with earthing eggs, housing following switch gears(Double door HORIZONTAL DB ) with i/c 1 Nos 63A TPN MCB o/g 12 nos SP MCB (6-32A) 10 KA Breaking Capacity	Set	2		
18	SITC of 4 way VTPN MCCB DB flush mounted on wall, sheet metal fabricated, powder coated, having dust-proof and vermin 'proof, gasketed and hinged door with all internals such as DIN rails, neutral link, interconnected wiring, complete with earthing legs, housing following switch gears (Double door VerticalL DB ) with i/c 1 Nos 63A TPN MCCB Thermal Magnetic Release Adjustable overload: 0.8-1.0 x In Adjustable Short Circuit: 6-10 x In o/g 12 nos SP MCB (6-32A) 10 KA Breaking Capacity	Set	1		
19	<b>SITC OF LT PANEL AS UNDER:</b> (Manufacturer must be approved from CPRI) Construction: Free Standing with front access, Dust & vermin Proof, Form 3b construction. Supply: 415V, 3Phase, 4 Wire, 50 Hz. Control Supply: 230V Single Phase Fault Level: 36KA for 1 Sec Fabrication: CRCA Sheet 14SWG for Gland Plate, Load Bearing Structure and Body, 16 SWG for partitions, doors and panels. 25x3 mm neoprene gasket for door, cover and gland plate. 40x5 mm gasket for joints and canopy. DC Locks to be provided on doors, danger plates on front and rear of bus bar chambers, live parts. Cable Entry / Exit : From top. Name plate: COPPER Powder Coating: Pre treated with 7 tank process and duly powder coated. TPN Busbars: 150A Rated coeper current density 1A/sq mm) with colour coded heat shrinkable sleeve. Neutral Bar of half size of Phase. Earth Bar of suitable size to be provided with earthing terminal on both ends Separate bus bar system to be provided for Emergency and Non Emergency supply outgoing Instrumentation: 1 Set 3 nos phase indicating lamps each backed up with MCB and switch shall be provided for each incomer. 1 no. VAF meter 0-200A with CT, selector switch, and fuse as reqd. Main Incomer- 120 A MCCB & 63 A MCCB for UPS Change Over - 1No. 100 A Manual Changeover & 1 No. 63 A Automatic changeover for UPS Non Emergency Outgoing - 1 Nos 63A MCCB Emergency Outgoing 2 Nos 63A MCCB, 2 Nos 63A FP MCB, 4 Nos 40A DP MCB One Section in outgoing section in both emergency and non emergency section be kept spare for future provisions	Set	1		
20	SITC of 200Amp Kit kat Fuse unit 3 nos with 200 Amp neutral link on wooden board (3' x 3') complete with connections (new).	Set	1		
21	S & I of earth pit comprising of G.I. earth pipe 4.5 metre long, 40 mm dia including necessary materials like charcoal,salt etc as required conforming to BIS standards having brick masonry chamber with hinged cover and watering arrangement.	Set	3		

22	Providing and fixing 25 mm X 5 mm GI strip on surface or in recess for connections etc. as required complete with insulation sleeve	RM	10		
23	Providing and fixing 4.00 mm dia copper wire on surface or in recess for loop earthing along with existing surface / recessed conduit/ submain wiring / cable as required	RM	50		
24	<b>Telephone point primary in PVC conduit:</b> Supply & fixing on wall/ furniture/ partition recessed type modular telephone socket outlet (RJ-11) with mounting box & front plate complete with chase cutting, mending good etc. as required complete including Supply & laying of 1 pair 0.5 mm dia. PVC insulated unarmoured telephone cables through PVC Conduit pipe (HMS) concealed in wall/ floor/ panelling/ partitions or above false ceiling as per requirement drawn from telephone tag block. The work shall also include for cutting chase for conduits and moulded boxes, if required, in the wall/ floor (Without damaging the building/wall) along with clamping the conduit at every 600mm interval & finally finishing the surface & matching the same with the existing surface. The rate should include the cost of all materials, labour, T&P, scaffolding, shifting of furniture, carting away the debris and cleaning the floor etc. The job shall be complete & to the entire satisfaction of the Bank. The above includes supply & fixing modular cover plates, base plates, PVC box/ Gang box in brick wall by making necessary chase/ recess and making good the same. All switches sockets and accessories must be modular. All new points must be provided in concealed/recessed conduit unless directed by architect / engineer in charge Interconnections to movable	Each	15		
25	Providing, laying and connecting PVC insulated copper telephone cable of following sizes including termination in approved manner. 20-pair telephone cable.	RM	25		
26	Providing and fixing of telephone tag block (Krone type) of 50 pair housed in GI box with cover of suitable size including termination	Each	1		
27	Supply and laying, effecting proper connections, testing & commissioning of the following sizes of 1.1 KV armoured/ unarmoured XLPE insulated PVC sheathed aluminium /copper conductor cables conforming to IS: 7098 Part 1 with latest amendments laid over MS supports in existing RCC ducts/ laid in ground /laid on Cable Trays including clamping the cables to supports in an approved manner as required complete with all accessories. Supply and laying of 3x6 sq mm armoured aluminium cable in existing pipe / cable tray	RM	45		
28	Supply and laying, effecting proper connections, testing & commissioning of the following sizes of 1.1 KV armoured/ unarmoured XLPE insulated PVC sheathed aluminium /copper conductor cables conforming to IS: 7098 Part 1 with latest amendments laid over MS supports in existing RCC ducts/ laid in ground /laid on Cable Trays including clamping the cables to supports in an approved manner as required complete with all accessories. Supply and laying of 3.5x50 armoured aluminium cable in existing pipe / cable tray	RM	50		
29	Supplying and making end termination with brass compression gland and aluminium lugs for following size of PVC insulated and PVC sheathed / XLPE aluminium conductor cable of 1.1 KV grade as reqd. End termination of 3.5x50 aluminium armoured cable	SET	20		
30	Supply, Installation, testing and commissioning of 2'X2' Recessed type LED LIGHT FITTINGS of 33-36 W with minimum lumen level of 3900 lumens, CRCA / Extruded aluminium housing, efficiency of 120 lumens per watt and Average life not less than 50000 hrs. The light should be hanged/supported by MS chain from ceiling directly and not be kept directly on false ceiling frame. Cutting of ceiling, framing etc. be included in the costs. Standard warranty of light fittings shall be minimum 2 years.	Each	40		
31	Supply, Installation, testing and commissioning of LED DOWNLIGHT FITTINGS of 15-18 W with minimum lumen level of 1650 lumens with die cast aluminium, efficiency of 110 lumens per watt and Average life not less than 30000 hrs. Cutting of ceiling, modifications required to the ceiling be included in the cost. Standard warranty of light fittings shall be minimum 2 years.	Each	60		
32	Supply Installation testing and commissioning of 4 ft, 18-20 watt LED batten with 2000 lumen output and 2 year warranty	Each	15		
33	Supply, Installation, Testing and commissioning of <b>100% metal body Wall mounted Fan</b> , 3/4 blade design, sweep 400-450 mm power input max 90 watt, Speed 1300-1330rpm with all	Each	20		
34	Ceiling Fan- Supply, Erecting, and testing of approved/specified make ceiling fans complete with down rod, canopy, blades and Electronic speed regulator 230-250 volts including connection with all necessary materials as required. Make- Usha/ Havells/Crompton	Each	1		
35	Supply & fixing of 230 mm exhaust fan <b>100% METAL body</b> with all accessories etc. complete of make As specified in tender document or approved by concerned office in charge.	Each	6		
36	Wiring for computer networking from Jack Panel in data rack to computer workstation with Cat-6 computer cable in PVC conduits of size 20/ 25 mm including providing ferrules at both ends and termination at both ends including providing & fixing frame for Cat-6 with shutter, RJ 45 outlet, faceplate and mounting box complete of modular type, this work includes supply and laying of CAT-6 cable in PVC conduits throughout the length, from the I/O hub to the point.	Nos.	25		
37	Providing & fixing 12 U (Rack with glass door, opening in the front power panel 1 (horizontal), cable manager 1 lock & key) with switch.	Nos.	1		
38	Supply & fixing, Installation, Testing & Commissioning of 24 port Jack Panel.	Nos.	1		
39	Supplying and fixing Patch Cord-2 Meter- (DBPS Mounting Cord)	Nos.	25		
40	Supplying and fixing Patch Cord-1 Meter-	Nos.	25		
41	Supplying and fixing CORDLESS call bell	Nos.	3		
42	Supply, Installation, testing and commissioning of recessed / suspended / hanged LED LIGHT FITTINGS size 6-0" long with minimum lumen level of 5500 lumens, CRCA/Extruded aluminium housing, efficiency of 120 lumens per watt and Average life not less than 50000 hrs, with following specification:- a. Superior efficacy of 120 lm/W, Suitable for Standalone & Continuous Mounting b. Up-Down lighting distribution & Uniform & volumetric light distribution c. Comfortable Light - CRI of 80 to ensure better color rendering & Minimum Bezel and height (33 mm for Down/45 11p-Down) d. Flexibility with NI Driver Options - Easy serviceability & CR190/R9-gt/>50 options, Indirect Lighting component, SDCM <lt/> 3 e. Higher efficacy helps to earn points of WELL & LEED & Lifetime: 50,000 Hrs. @ Ta45°C, BIS Approbation - Safe and Reliable performance & THD<lt/>10% - Higher power factor, lower peak currents, and higher efficiency. f. Flicker Free Lighting Effects New light platform and optical design with ripple <lt/> 5% & Lighting solution with high uniformity provides comfort in office lighting experience & Connected ready(Dali/interact) versions available for Smart offices/workspaces g. Multiple Lumen Multiple Lumen Packs & CCT - For different office applications and mounting heights.	Nos.	4		
43	Supply, Installation, Testing & Commissioning of 4 watt per meter (300 lumen per meter) LED TUBULAR cove Light with high efficiency electronic driver. (Make- Philips)	RM	100		
44	SITC-18W LED Surface COB lights make- Philips/ havells/ wipro	Nos.	8		
45	SITC-Ceiling Profile Ligh Type TruGroove, Installation/ mounting type Recessed, Color Temperature Tc(K)3000/3500/4000 Housing (Material And Finish) Extruded aluminum trim and die-cast end plates, System Wattage 20W, C classifications (IP/IK)IP20, 2" Inch Yellow Colour Cover (Glass/PC) Polycarbonate, Electrical Class II, / LED Lamps 240 Nos/Mtr (LM26)5mtr roll with LED Driver lumens (Make IP Mac, Sanspa, Helius, )	RM	40		
	<b>TOTAL AMOUNT</b>				
	GST extra as applicable				

**APPROVED MAKE LIST**

S.N.	DESCRIPTION	Approved Makes
S.N.	PVC Conduit	Precision/AKG /VIP
1	Ceiling Junction Boxes	Home lite/ANCHOR
2	Wires & cables	R.R./Havells/ Polycab
3	Modular Switches, Sockets etc	Crabtree / Northwest /Legrand
4	Lighting Fixtures	Philips/Wipro/Havells
5	M.C.B./RCCB/RCBO etc	Legrand/Havells/ HAGER
6	Distribution Boards	Same As Above
7	MCCB	Schneider/Legrand/Havells
8	Change Over Switches	A.B.B./Standard/ L.& T.
9	End Termination accessories	Dowells/Usha/Brecco/Cosmos
10	Telephone Cables & accessories	Havells, Krone, Finolex,
11	Fans/Exhaust fans	Crompton/Havell/USHA
12	Music Speakers	Philips/Bosch/Ahuja
13	Amplifiers	Philips/Bosch/Ahuja
14	DVR	Samsung, Honeywell , HIKVISION
15	Rg11, CAT5/CAT6 cables/Telephone wires	Legrand, Molex, D'Link ,AMP
16	CCTV Dome Camera	Honywell, HIKVision
17	Hard Disk drive	Seagate, HIKVISION
18	Smoke/Heat/Optical Fire Detectors	Edward, Siemens, Appolo Or other
19	Response Indicators, Hooters	Edward, Siemens OR other ISI
20	Telephone Tag Block	Krone
Place:		

UNION BANK OF INDIA  
(ZONAL OFFICE)

UNION BANK OF INDIA  
(ZONAL OFFICE)

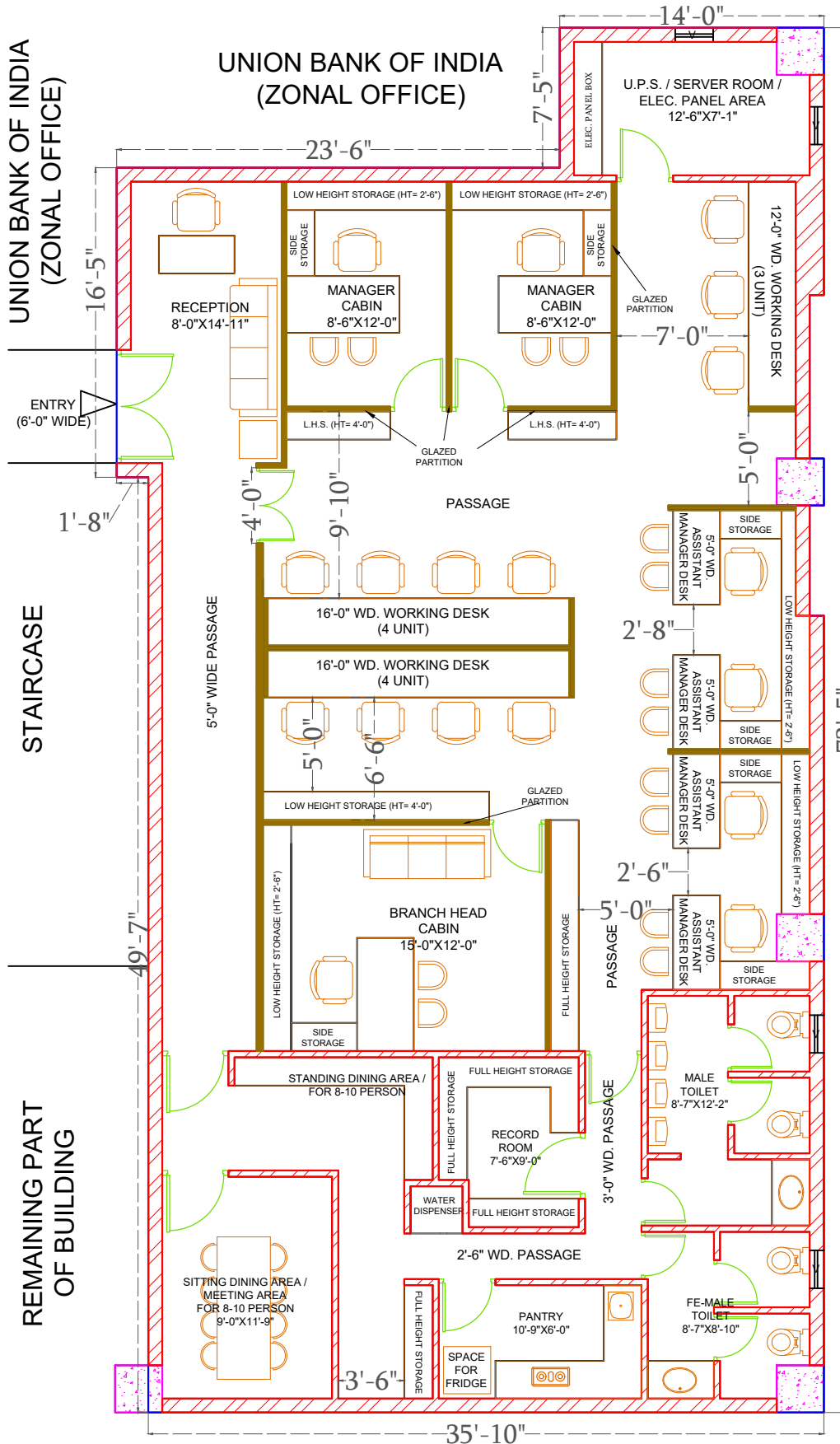

STAIRCASE

BALCONY / OPEN TO SKY

REMAINING PART  
OF BUILDING

REMAINING PART OF BUILDING

**SECOND FLOOR PLAN  
(PROPOSED)**

PROJECT TITLE:  
PROPOSED PLANNING FOR UNION BANK OF INDIA, ZONAL AUDIT OFFICE / ENQUIRY CELL/ ZONAL VIGILANCE CELL, MEERUT, UTTAR PRADESH

LEGEND :

- BRICK WORK
- WOODEN PARTITION
- CONC. WORK
- PREMISES BOUNDARY

NORTH:

OPTION :	E
DATE :	05.05.2026
DRAWING NO. :	01
SHEET NO. :	01
SCALE :	1:100
REVISION :	
REVISION NO :	
REV. DATE :	
DRAFTED BY :	Ar. SHUBHAM PAL
CHECKED BY :	Ar. HIMANSHU JAIN
ARCHITECT SIGN & STAMP :	

COMPANY NAME, ADDRESS & CONTACT NO.  
SPIRECTECH SPACES AND ARCHITECTS (OPC) PRIVATE LIMITED  
REG OFF. : UNIT NO. 241/1, SHIV SHANKAR PURI, SHARDA ROAD, DISTT. MEERUT (UTTAR PRADESH)-250002  
CONTACT NO. : 9045125056  
EMAIL ID : AR.HIMANSHUJAIN21@GMAIL.COM